

Soils Map

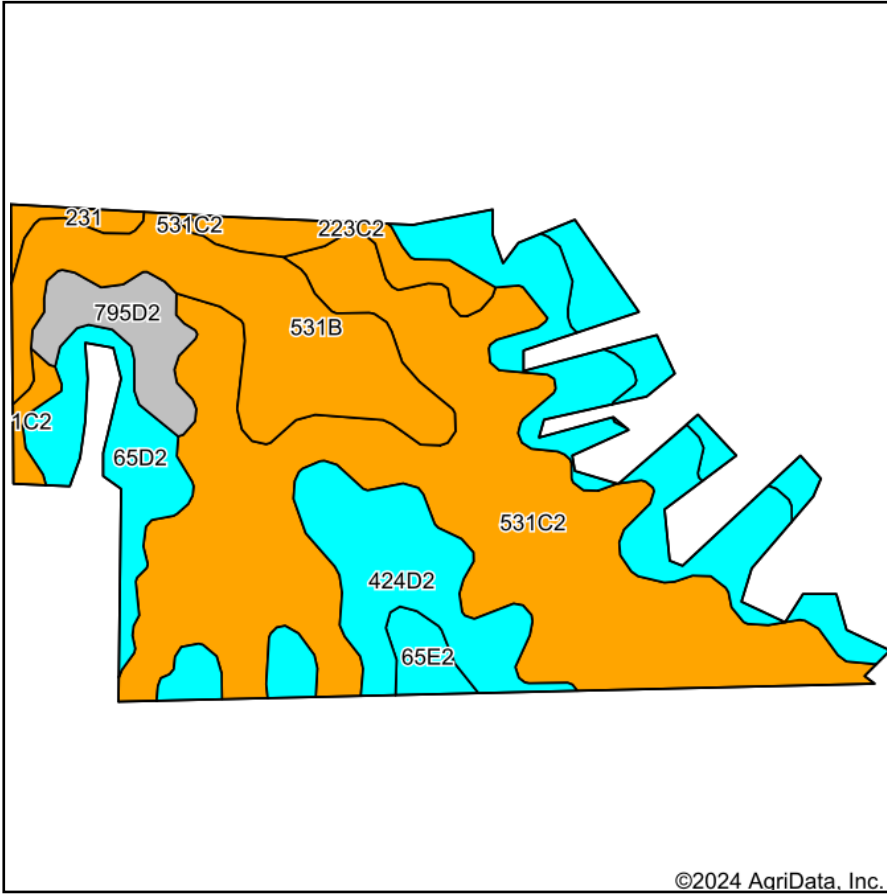

Soils data provided by USDA and NRCS.

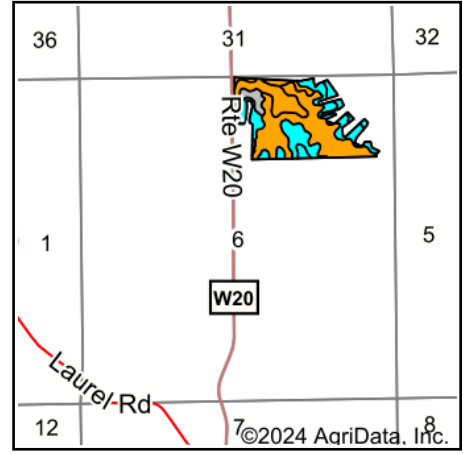

State: **Iowa**
 County: **Van Buren**
 Location: **6-67N-9W**
 Township: **Vernon**
 Acres: **50.56**
 Date: **2/6/2024**



Maps Provided By:



Area Symbol: IA177, Soil Area Version: 31

Code	Soil Description	Acres	Percent of field	CSR2 Legend	Non-Irr Class *c	CSR2**	CSR	*n NCCPI Soybeans	
531C2	Kniffin silty clay loam, 5 to 9 percent slopes, moderately eroded	22.74	45.0%		Ille	48	31	60	
424D2	Lindley-Keswick loams, 9 to 14 percent slopes, moderately eroded	10.33	20.4%		IVe	27	15	50	
531B	Kniffin silt loam, 2 to 5 percent slopes	6.77	13.4%		Ille	55	54	66	
65D2	Lindley loam, 9 to 14 percent slopes, moderately eroded	4.03	8.0%		IVe	37	38	54	
65E2	Lindley loam, 14 to 18 percent slopes, moderately eroded	2.52	5.0%		VIe	29	28	53	
795D2	Ashgrove silty clay loam, 9 to 14 percent slopes, moderately eroded	2.15	4.3%		IVe	7	8	39	
223C2	Rinda silty clay loam, 5 to 9 percent slopes, moderately eroded	1.53	3.0%		IVw	45	22	46	
231	Edina silt loam, 0 to 2 percent slopes	0.49	1.0%		Illw	59	63	64	
Weighted Average						3.51	41.1	30.3	*n 56.7

**IA has updated the CSR values for each county to CSR2.

*n: The aggregation method is "Weighted Average using all components"

**IA has updated the CSR values for each county to CSR2.*c: Using Capabilities Class Dominant Condition Aggregation Method